



Solar GEL Deep Cycle Battery

SPACEFLIGHT POWER Solar GEL Deep Cycle Battery is a hybrid GEL battery designed with deep cycle technology to provide extra-durable cycle performance for solar energy System. It offers more than 600 cycles at 80% DOD.

Applications

- Solar and wind power systems
- Communication systems
- Uninterruptible power supplies
- Alarm and security system

General Features

- 12 years designed floating life(25 °C)
- Non-spillable construction
- Sealed and maintenance-free
- Excellent recovery from deep discharge
- High density active materials plates
- Longer Life and low self-discharge

Standards

- Compliance with IEC, BS, JIS and EU standards.
- UL, CE Certified
- ISO45001,ISO9001 and ISO14001 certified production facilities

Specifications

| | | |
|---------------------------------|----------------------------------|---|
| Rated Voltage | 12V | |
| Nominal Capacity | 150Ah | (C ₁₀ , 10.8V) |
| Approx Weight | 43kg±3%(94.8lbs) | |
| Terminal | F12 | |
| Rated Capacity(25°C) | 157 Ah | (20hr,7.85A,10.5V) |
| | 150 Ah | (10hr,15A,10.8V) |
| | 133 Ah | (5hr,26.6A,10.5V) |
| | 97 Ah | (1hr,97.0A,9.6V) |
| Max.Discharge Current | 1500A(5s) | |
| Max.Charge Current | 37.5A | |
| Internal Resistance(25°C) | Approx 4.5mΩ | |
| Operating Temp.Range | Discharge | -20~60 °C(-4~140 °F) |
| | Charge | -10~50 °C(14~122 °F) |
| | Storage | -20~60 °C(-4~140 °F) |
| Nominal operating temperature | 25±5 °C | |
| Charge Voltage @25°C(77 °F) | Cycle Use | Initial Charging Current less than 37.5A. Voltage 14.4V~15.0V at 25°C(77°F)Temp. Coefficient -30mV/°C |
| | Standby Use | Initial Charging Current less than 37.5A. Voltage 13.5V~13.8V at 25°C(77°F)Temp. Coefficient -20mV/°C |
| Temperature effects on capacity | 40 °C (104 °F) | 103% |
| | 25 °C (77 °F) | 100% |
| | 0 °C (32 °F) | 86% |
| | -15 °C (5 °F) | 65% |
| Self Discharge(25°C) | Capacity after 3 months storage | 91% |
| | Capacity after 6 months storage | 82% |
| | Capacity after 12 months storage | 65% |



Dimensions

unit:mm

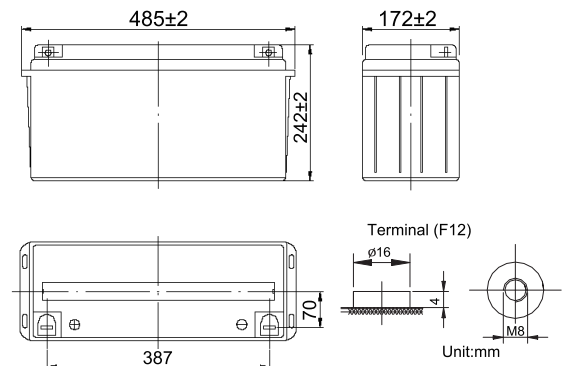

| | |
|------------------|-----------------------|
| Length | 485±2mm (19.1 inches) |
| Width | 172±2mm (6.77 inches) |
| Container Height | 242±2mm (9.52 inches) |
| Total Height | 242±2mm (9.52 inches) |

Battery Construction

| Component | Positive plate | Negative plate | Container | Safety valve | Terminal | Separator | Electrolyte |
|--------------|----------------|----------------|-----------------------------|--------------|----------|-----------|--|
| Raw material | Lead dioxide | Lead | ABS(UL94-HB) or FR(UL94-V0) | Rubber | Copper | AGM | SiO ₂ +H ₂ SO ₄ |

Constant Current Discharge (Amperes) at 25°C(77°F)

| E.V/Time | 5min | 10min | 15min | 30min | 1h | 3h | 5h | 10h | 20h |
|----------|------|-------|-------|-------|------|------|------|------|------|
| 1.60V | 445 | 347 | 282 | 163 | 97.0 | 40.1 | 28.1 | 15.5 | 7.93 |
| 1.65V | 415 | 327 | 267 | 158 | 95.0 | 39.4 | 27.6 | 15.4 | 7.90 |
| 1.70V | 384 | 306 | 253 | 153 | 93.0 | 38.5 | 27.1 | 15.3 | 7.90 |
| 1.75V | 352 | 286 | 239 | 147 | 91.0 | 38.0 | 26.6 | 15.2 | 7.85 |
| 1.80V | 317 | 263 | 226 | 144 | 89.0 | 37.4 | 26.0 | 15.0 | 7.80 |

Constant Power Discharge (Watts/cell) at 25°C(77°F)

| E.V/Time | 5min | 10min | 15min | 30min | 45min | 1h | 2h | 3h | 5h |
|----------|------|-------|-------|-------|-------|-----|-----|------|------|
| 1.60V | 765 | 609 | 501 | 325 | 221 | 201 | 112 | 78.0 | 53.5 |
| 1.65V | 734 | 579 | 483 | 315 | 216 | 198 | 110 | 77.1 | 53.2 |
| 1.70V | 686 | 548 | 465 | 306 | 211 | 195 | 108 | 76.2 | 52.8 |
| 1.75V | 638 | 519 | 446 | 296 | 206 | 190 | 106 | 75.3 | 52.5 |
| 1.80V | 591 | 487 | 425 | 286 | 202 | 184 | 105 | 74.0 | 52.0 |

Note: The above characteristics data are average values obtained Within three charge/discharge cycles not the minimum.

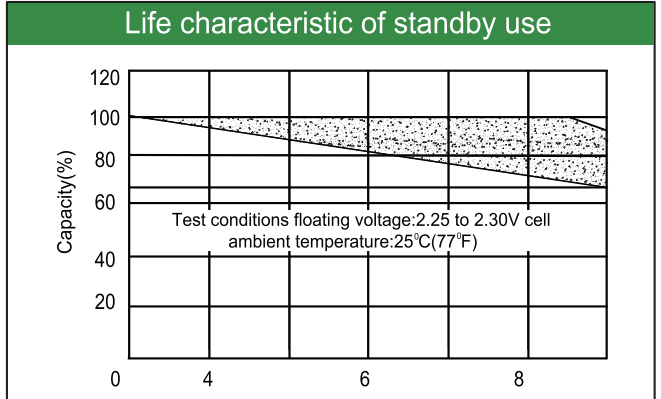
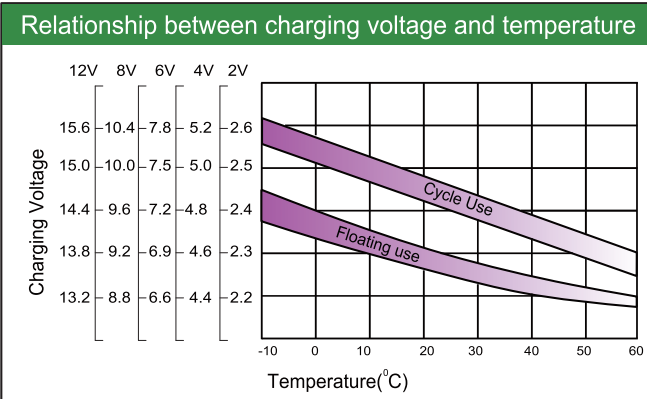
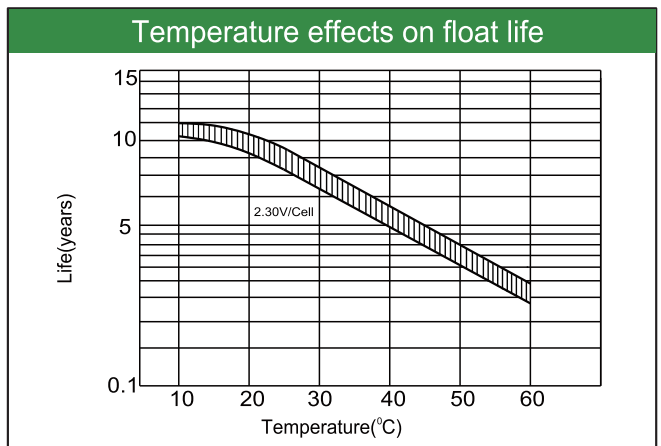
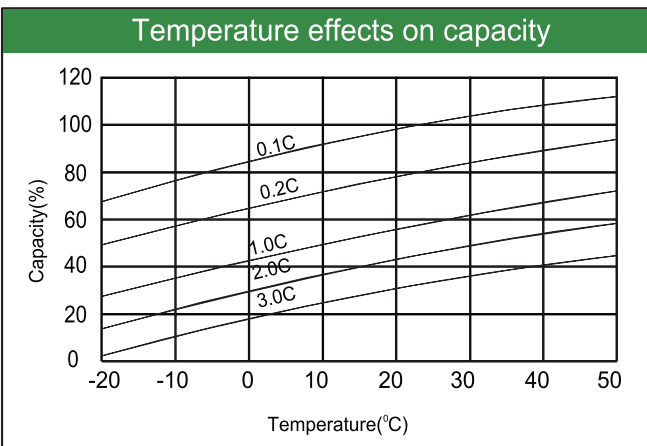
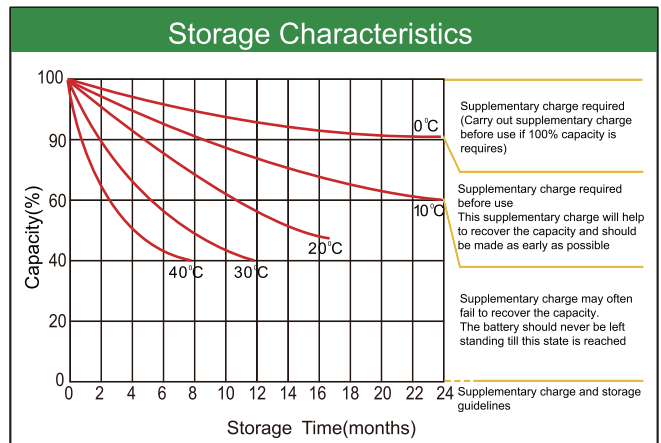
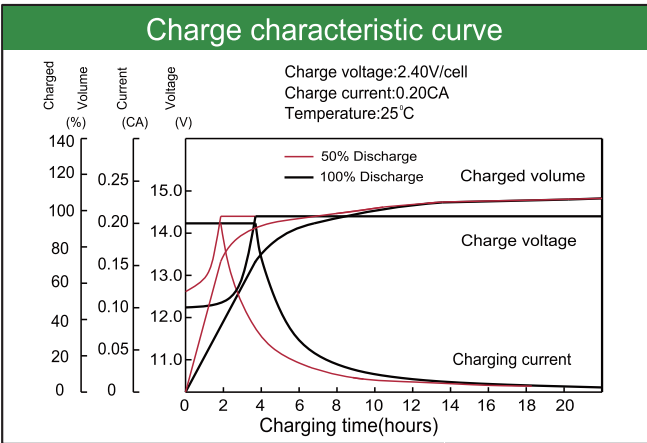
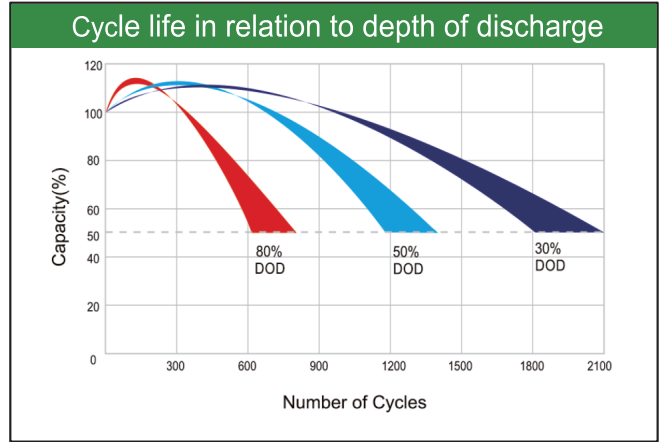
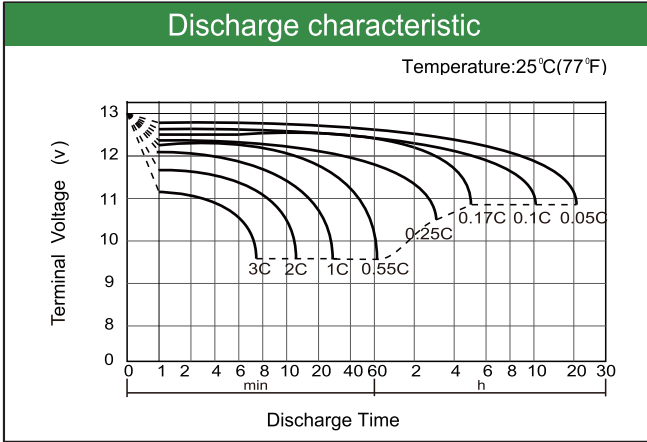

Factory Address: Fukang industrial park, LongNan, GanZhou JianXi.
Office add: RM208-210, Building D, Tongju industrial Park, No.4, Longping West Road, Longgang District, Shenzhen.
TEL: +86-755-28288189 sales@sfbattery.com www.sfbattery.com